



Foamalux

Foam PVC Sheets



DESIGN.
CREATE.
INNOVATE.



Foamalux

Design, create & innovate with Foamalux Foam PVC

With bright white, matt and gloss, colours and environmentally friendly options for digital and screen printing, cutting, routing, engraving, forming, vinyl graphics, bending, shaping and bonding - there has never been a greater choice.

White | Light | Colour | Ultra | Xtra | Eco

Brett Martin is a leading international manufacturer of a range of sign and display substrates. The company works in partnership with a worldwide network of distributors to supply the versatile and durable Foamalux range.

CONTENTS

04	Features & Benefits
06	Applications
08	Foamalux Range
10	Foamalux White
12	Foamalux Light
14	Foamalux Colour
16	Foamalux Ultra
18	Foamalux Xtra
20	Foamalux Eco
22	Foamalux Calibre
24	Material Properties



Features & Benefits



Lightweight

Even in large format, Foamalux is only a fraction of the weight of solid display material of similar strength, making it much easier to handle and install.

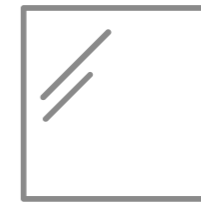

Smooth

The smooth, flat and flawless surface of Foamalux provides a consistently even and reliable high performance surface for different types of printing and mounting.



Strong

Offering an exceptional strength to weight ratio, Foamalux provides a rigid sheet which is durable and offers superior resistance to knocks and scratches.



Moisture Resistant

Foamalux is moisture and mould resistant so will not rot or decay.



Low Flammability

Foamalux offers excellent fire performance and has been independently tested to various Fire Standards. For the correct certification for your location, please contact the Technical Department.

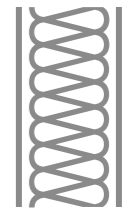

Insulation

Provides acoustic and thermal insulation.



Performance

Foamalux is a durable, versatile and flexible material suitable for indoor and short term outdoor use.

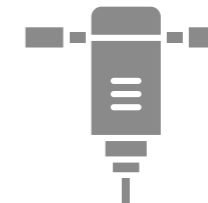

Ease of Fabrication

Foamalux is easily cut, routed, engraved, drilled, printed, thermoformed and bonded.



Recyclable

Non-toxic, REACH and RoHS compliant, and 100% recyclable.

Applications

Sign & Display

Our Foamalux range has a smooth surface which is optimised for print. It is also easy to fabricate and thermoform, making it perfect for signage, point of sale and 3D displays.

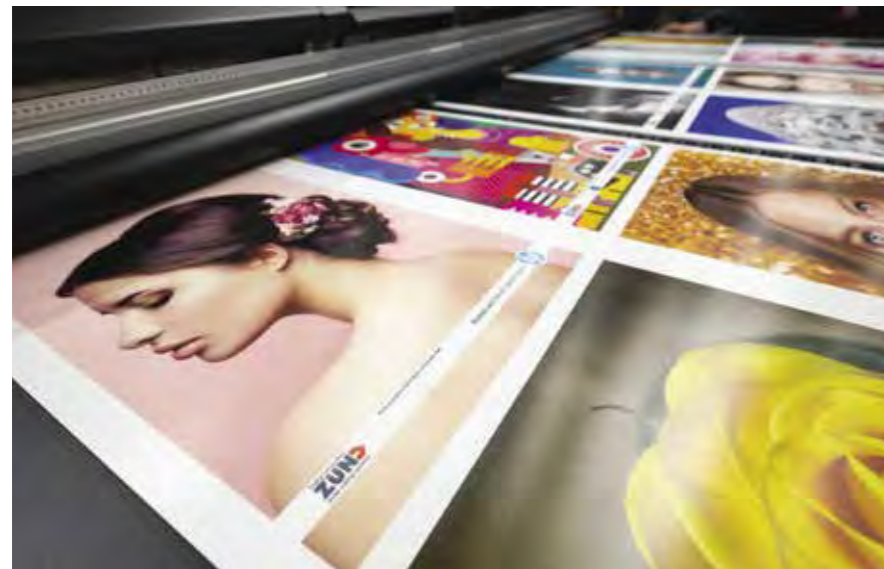

Outfitting

Foamalux is low maintenance, lightweight and easy to assemble making it ideal for shopfitting, hospitality or office fit outs or temporary constructions such as pop-ups and exhibition stands.

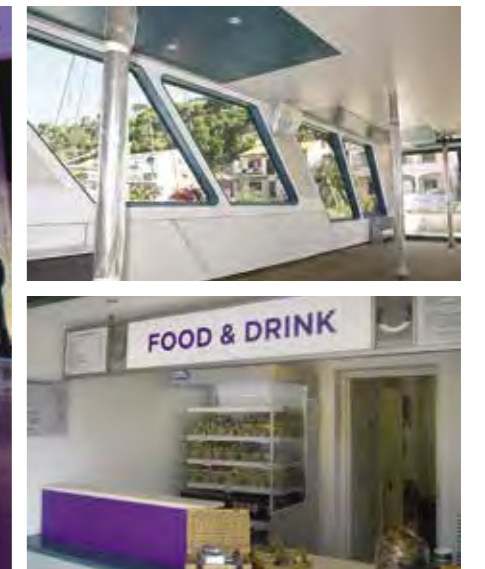

Fabrication

Foamalux can be easily printed, cut, drilled, shaped and bonded allowing flexibility and creativity of design when fabricating everyday products or one-off items.



Pet and Animal Enclosures

Foamalux is ideal for pet and animal enclosures. It is low maintenance, and does not need to be painted. It provides good thermal insulation, is non-toxic, waterproof and mould proof.



FOAMALUX RANGE

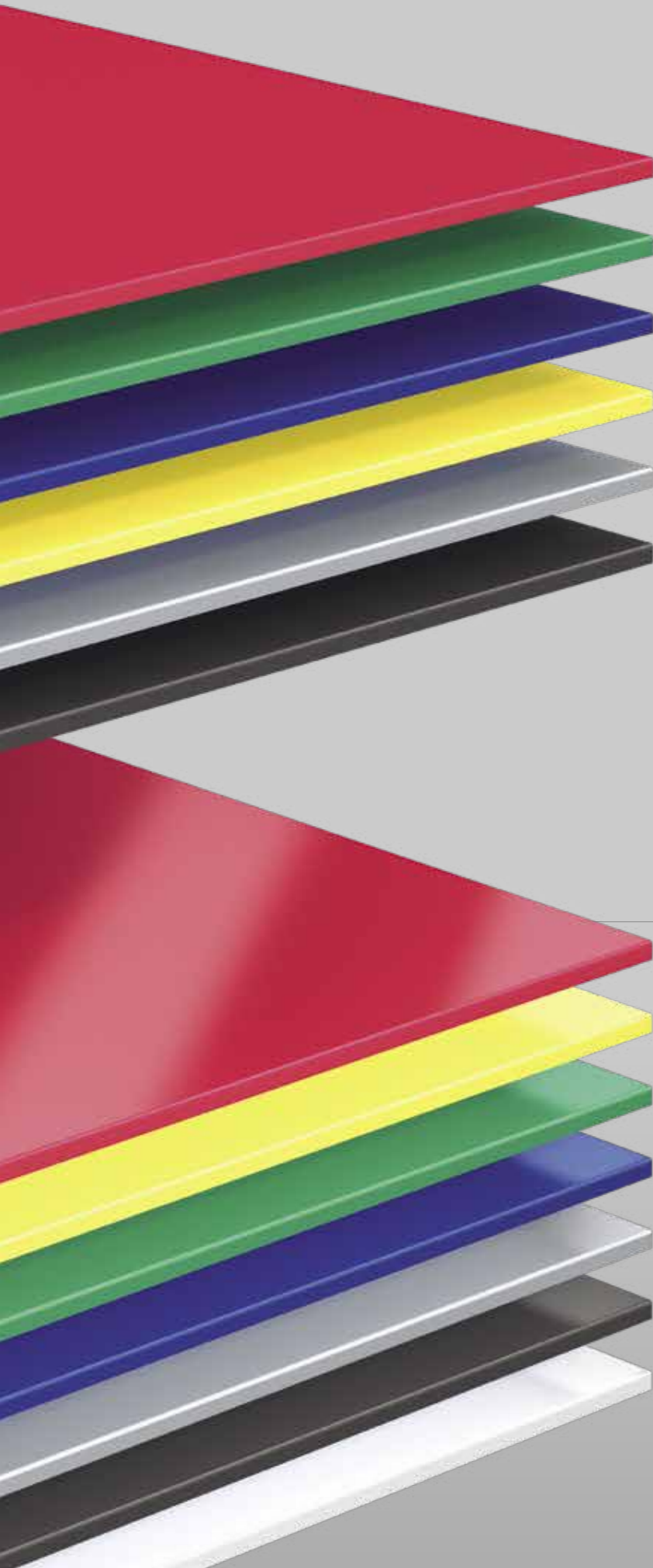

Foamalux Colour

VIBRANT COLOUR RANGE

Sheet Size (mm)	Thickness (mm)
1220 x 2440	3 & 5
2050 x 3050	3 & 5

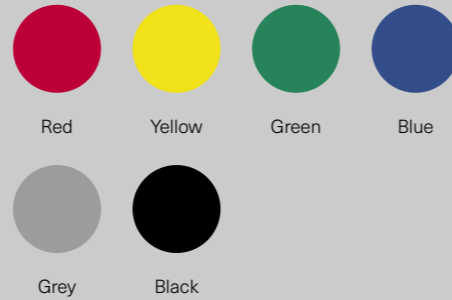

Foamalux Ultra

HIGH GLOSS FINISH

Sheet Size (mm)	Thickness (mm)
1220 x 2440	3 & 5



Foamalux White

PREMIUM CHOICE WHITE SHEET

Sheet Size (mm)	Thickness (mm)
1220 x 2440	1, 2, 3, 4, 5, 6, 8, 10, 13, 19 & 24
1560 x 3050	2, 3, 5, 10, 15 & 19
2050 x 3050	1, 2, 3, 4, 5, 6, 8 & 10

Foamalux Light

IDEAL FOR DIGITAL PRINTING

Sheet Size (mm)	Thickness (mm)
1220 x 2440	2, 3, 4, 5, 6, 8 & 10
1560 x 3050	2, 3, 5, & 10
2050 x 3050	2, 3, 4, 5, 6, 8 & 10

Foamalux Eco



THE GREEN CHOICE

Sheet Size (mm)	Thickness (mm)
1220 x 2440	3, 5 & 10
2050 x 3050	3, 5 & 10

Foamalux Xtra



ENVIRONMENTALLY FRIENDLY

Sheet Size (mm)	Single Sided Thickness (mm)	Double Sided Thickness (mm)
1220 x 2440	3, 5 & 6	10
1560 x 3050	-	10
1560 x 4050	-	10

Foamalux Calibre

PVC CONSTRUCTION BOARD

Sheet Size (mm)	Thickness (mm)
1220 x 2440	10, 19, 24 & 30
1220 x 3050	10, 19, 24 & 30





Foamalux Xtra

Environmentally Friendly

Foamalux Xtra is the environmentally friendly sign and display solution. Containing up to 80% reclaimed content, Foamalux Xtra uses waste that would otherwise go to landfill making it a greener choice. It comprises a black core, manufactured from post-production waste, with one or two surfaces of premium quality virgin white PVC, making it ideal for engraving to reveal the core or printing on the white surface.

Environmentally friendly reclaimed black core

Bright white surface, excellent for printing

Suitable for engraving applications

Single or double sided sheet formats

Consistently smooth and even

Hard and resilient

Quality digital and screen printing

Excellent vinyl adhesion

Easy to clean

100% recyclable

Sheet Size (mm)	Single Sided (S1) Thickness (mm)	Double Sided (S1) Thickness (mm)
1220 x 2440	3, 5 & 6	10
1560 x 3050	-	10
1560 x 4050	-	10

Applications

Signage, Digital and screen printing, Vinyl application, POS and 3D displays, Shop fitting, Exhibition stands, Fabrication, Pet and animal enclosures

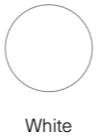

Material Properties

Foamalux White

PROPERTY	STANDARD	VALUE	UNITS
Density	-	0.55-0.75	g/cm ³
Moisture Absorption	ISO 62	<0.25	% by weight
Shore Hardness	ISO 868	>30	-
Tensile Strength	ISO 527	15	MPa
Flexural Modulus	ISO 178	1100-1300	MPa
Impact Resistance (Charpy)	ISO 179-1/1eU	11	kJ/m ²
Thermal Expansion	ISO 11359-2	0.068	mm/m°C
Service Temperature	-	-20 to +60	°C

Foamalux Colour

PROPERTY	STANDARD	VALUE	UNITS
Density	-	0.50	g/cm ³
Moisture Absorption	ISO 62	<0.25	% by weight
Shore Hardness	ISO 868	>30	-
Tensile Strength	ISO 527	15	MPa
Flexural Modulus	ISO 178	900-1100	MPa
Impact Resistance (Charpy)	ISO 179-1/1eU	14	kJ/m ²
Thermal Expansion	ISO 11359-2	0.068	mm/m°C
Service Temperature	-	-20 to +60	°C

Foamalux Xtra

PROPERTY	STANDARD	VALUE	UNITS
Density	-	0.55-0.65	g/cm ³
Moisture Absorption	ISO 62	<0.25	% by weight
Shore Hardness	ISO 868	>30	-
Tensile Strength	ISO 527	17	MPa
Flexural Modulus	ISO 178	1000-1200	MPa
Impact Resistance (Charpy)	ISO 179-1/1eU	12	kJ/m ²
Thermal Expansion	ISO 11359-2	0.068	mm/m°C
Service Temperature	-	-20 to +60	°C

Foamalux Calibre

PROPERTY	STANDARD	VALUE	UNITS
Density	-	0.5	g/cm ³
Shore Hardness	ISO 868	>40	-
Thermal Expansion	ISO 11359-2	0.068	mm/m°C
Service Temperature	-	-20 to +60	°C
Moisture Absorption	ISO 62	<2	% by weight
Screw Pull	ASTM D1761-20	65	N/mm

Foamalux Light

PROPERTY	STANDARD	VALUE	UNITS
Density	-	0.45-0.55	g/cm ³
Moisture Absorption	ISO 62	<0.25	% by weight
Shore Hardness	ISO 868	>30	-
Tensile Strength	ISO 527	15	MPa
Flexural Modulus	ISO 178	900-1100	MPa
Impact Resistance (Charpy)	ISO 179-1/1eU	10	kJ/m ²
Thermal Expansion	ISO 11359-2	0.068	mm/m°C
Service Temperature	-	-20 to +60	°C

Foamalux Ultra

PROPERTY	STANDARD	VALUE	UNITS
Density	-	0.60-0.80	g/cm ³
Moisture Absorption	ISO 62	<0.25	% by weight
Shore Hardness	ISO 868	>50	-
Tensile Strength	ISO 527	25	MPa
Flexural Modulus	ISO 178	1600-1800	MPa
Impact Resistance (Charpy)	ISO 179-1/1eU	14	kJ/m ²
Thermal Expansion	ISO 11359-2	0.068	mm/m°C
Service Temperature	-	-20 to +60	°C

Foamalux Eco

PROPERTY	STANDARD	VALUE	UNITS
Density	-	0.50-0.60	g/cm ³
Moisture Absorption	ISO 62	<0.25	% by weight
Shore Hardness	ISO 868	>30	-
Tensile Strength	ISO 527	15	MPa
Flexural Modulus	ISO 178	900-1100	MPa
Impact Resistance (Charpy)	ISO 179-1/1eU	12	kJ/m ²
Thermal Expansion	ISO 11359-2	0.068	mm/m°C
Service Temperature	-	-20 to +60	°C



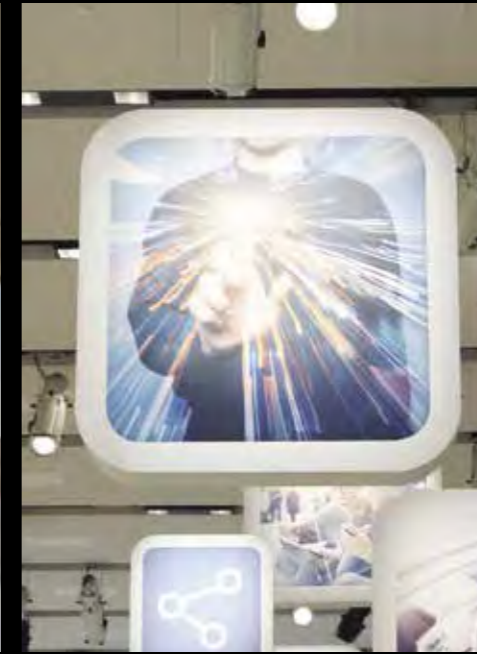

Brett Martin Ltd

24 Roughfort Road
Newtownabbey
Co. Antrim
BT36 4RB

1721/1121

t: +44 (0) 28 9084 9999
f: +44 (0) 28 9083 6666
e: technical@brettmartin.com
commercial@brettmartin.com

For the latest information visit
brettmartin.com



All reasonable care has been taken in the compilation of the information contained within this literature. All recommendations on the use of our products are made without guarantee as conditions of use are beyond the control of Brett Martin. It is the customer's responsibility to ensure that the product is fit for its intended purpose and that the actual conditions of use are suitable. Brett Martin pursues a policy of continuous product development and reserves the right to amend specifications without prior notice. Foamalux is a registered trademark of Brett Martin Ltd.